

PRODUCT

OONA MINI 01
INSTALL GUIDE

DESCRIPTION

OONA IS AN ARTISAN-CRAFTED HANGING PENDANT FEATURING A HAND-FORMED BRASS SHADE THAT ROTATES AROUND A GLASS FORM

MATERIALS

BOROSILICATE GLASS
FORMED AND MACHINED BRASS

NOTES

- OONA SHOULD BE INSTALLED BY A LICENSED INSTALLATION PROFESSIONAL AND IS MEANT TO BE ASSEMBLED AND CONFIGURED ON-SITE
- THIS FIXTURE IS INTENDED TO BE INSTALLED UTILIZING A NEC COMPLIANT JUNCTION BOX WITH A PLASTER RING
- OONA IS DIMMABLE WITH STANDARD INCANDESCENT DIMMING HARDWARE (WHEN USING INCANDESCENT BULBS)
- OONA IS HANDMADE BY ARTISANS. INCONSISTENCIES IN COLOR, SHAPE, AND SIZE NATURALLY OCCUR AND MAKE EVERY PIECE UNIQUE
- LAMPING: E26 BASE / A23 SHAPE / 120V / 25 WATT MAX

MODEL: OONA MINI
RATING: 120V 60Hz, 25 W MAX
CONFORMS TO UL STD 1598
CERTIFIED TO CSA STD C22.2 No.250.0

5009608



Intertek

**DRY LOCATIONS ONLY
POUR EMPLACEMENTS SECS SEULEMENT
ASSEMBLE PARTS OONA ONLY WITH PART
CANOPY.
ASSEMBLER LA PIECE OONA SEULEMENT
AVEC LA PIECE CANOPY**

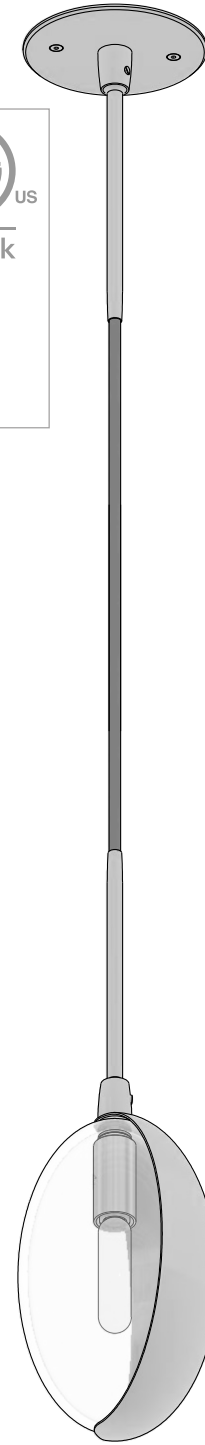

AMERICAN DESIGN
BY LAKE  WELLS
CHICAGO

OONA CANOPY

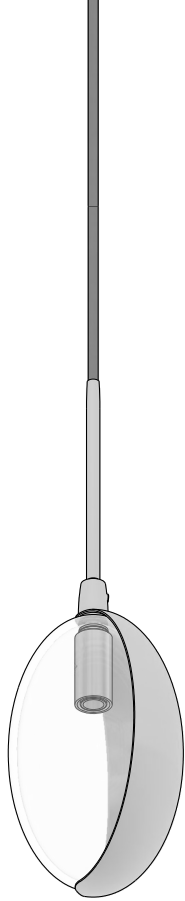
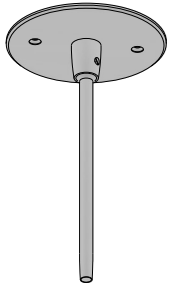

OONA MINI
PENDANT

PARTS

• Review and take note of all the components your order came with.

• **INSTALLATION REQUIRES A JUNCTION BOX WITH A ROUND PLASTER RING.**

1

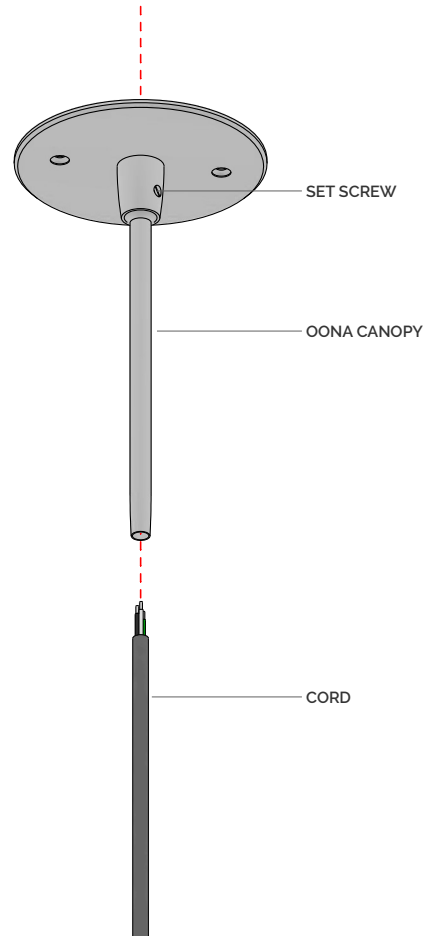

• Loosen (*do not remove*) the SET SCREW on the OONA CANOPY.

• Feed the fixture CORD through the OONA CANOPY stem until desired drop length is achieved.

• When desired drop length is achieved, tighten the SET SCREW to secure the fixture CORD in place.

2

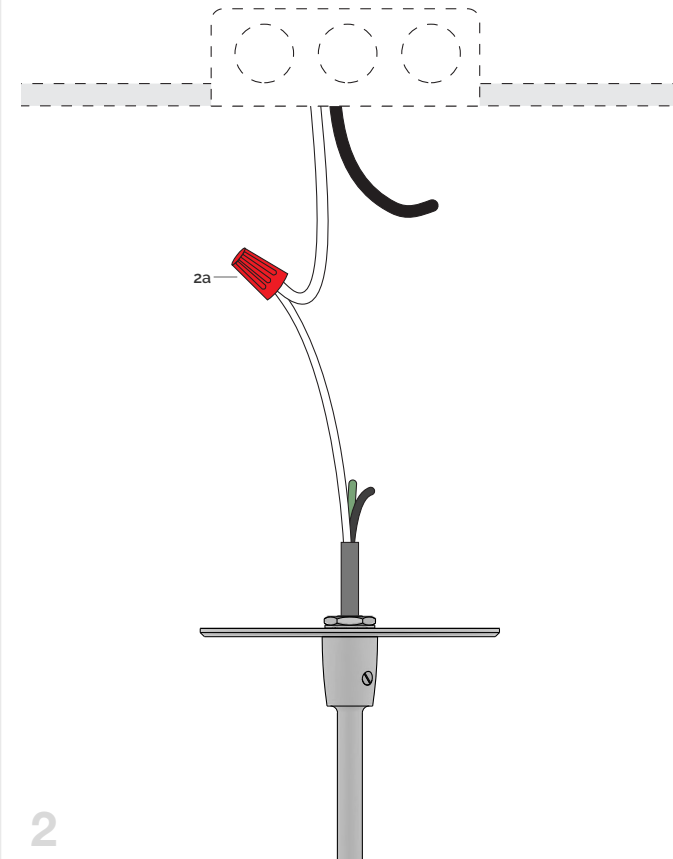

• **BE SURE THAT ALL POWER IS OFF TO THE JUNCTION BOX**

• Trim any excessive cord from each pendant.

2a • Connect the neutral power cord with the white fixture wire using the provided wire nut.

• Repeat step 2a for the hot power cord wire with the black fixture wire using the provided wire nut.

• Ground the fixture wire according to local electrical code.

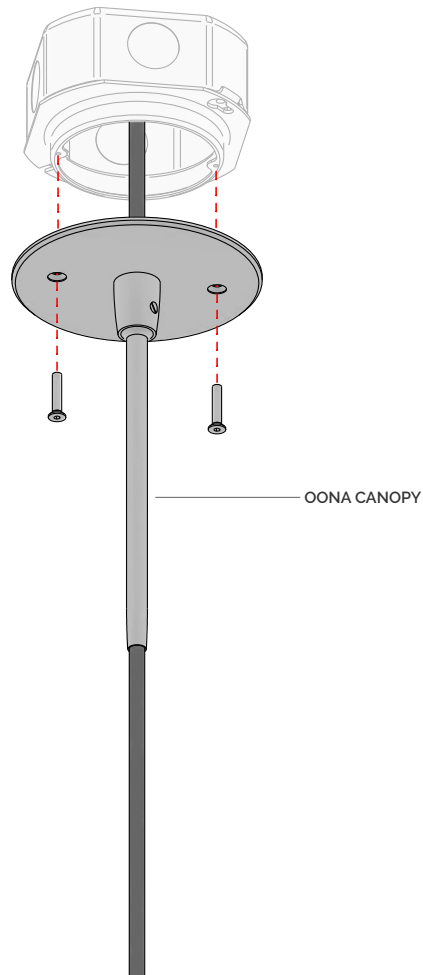

3

- Installation requires a junction box with a round plaster ring.
- Carefully fit all cords into the junction box.
- Using the included screws, attach the OONA CANOPY to the junction box and fully tighten screws.

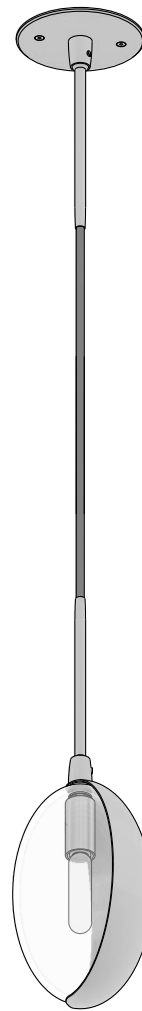

4

- Double check to make sure the OONA CANOPY is securely attached to the junction box and that the strain relief SET SCREW is securely tightened.
- At this point, fixture installation is complete. You may now install a standard E12 base lamp.

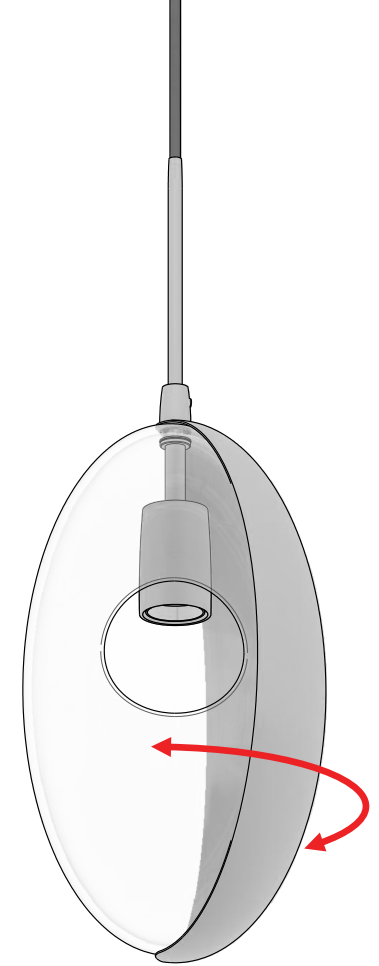

MAINTENANCE

BULB INSTALLATION / REPLACEMENT

Hold the metal shade securely with one hand while slowly rotating the glass with your other hand until the side access hole in the glass is exposed.

Be careful to not let the glass rub along the inside of the metal shade. Captured debris can scratch the glass and shade.

CLEANING

Clean by using a dry or slightly dampened cloth. Only use fine cotton or extra soft cloths. Glass cleaner with no additives may be used on the glass.